



The cutting-edge traffic enforcement systems

## FEATURES

- High precision laser-based vehicle speed detection
- Recording traffic regulation violations (with PreTrigger technology)
- Automatic and manual operation
- Portable or Stationary version
- Automatic licence plate recognition (ALPR)
- Day and night mode
- Up to 1600m speed measurement distance
- Up to 160m daytime, 100m nighttime image capturing
- Saved calibrated camera parameters
- Embedded WLAN, GPS, 3G units
- DMC position sensor
- High definition touchscreen
- Up to 4 hours operation time
- True Speed Measurement Filter (TSMF)
- Embedded Solution for Driver Identification (ESDI)
- Vehicle-mounted version for pursuit car (with the seat adapter bracket)
- Target Position Detection (TPD)

## BENEFITS

- Ultraportable
- Detection of the measured vehicle's position by TPD
- Sunlight Readable TFT Display
- Operation in moving car
- No moving parts
- Hot swapping battery
- User-friendly graphical user interface
- Easy and quick setup
- One button measuring distance settings
- Police reference

*Not all of the features mentioned above are available in every type.*

## APPLICATION

### Portable Installation

### SPEEDCAPTURE PORTABLE

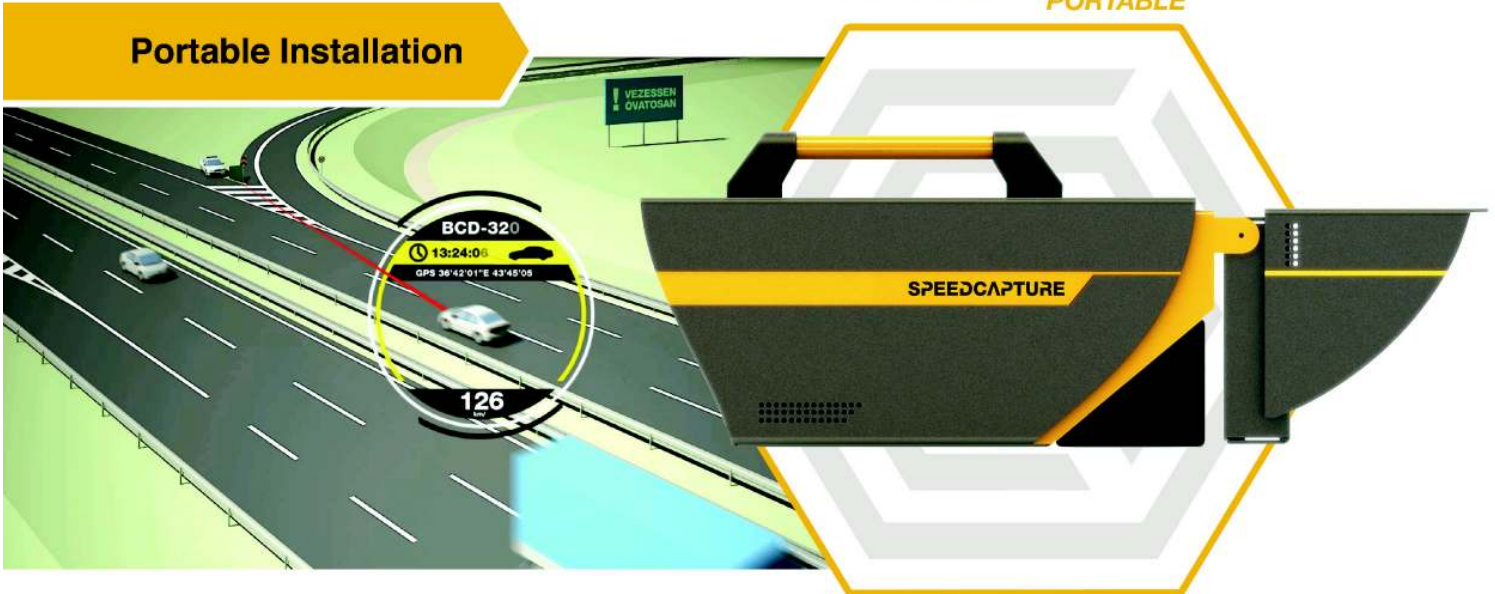

### SPEEDCAPTURE MULTISYSTEM

### Stationary Installation

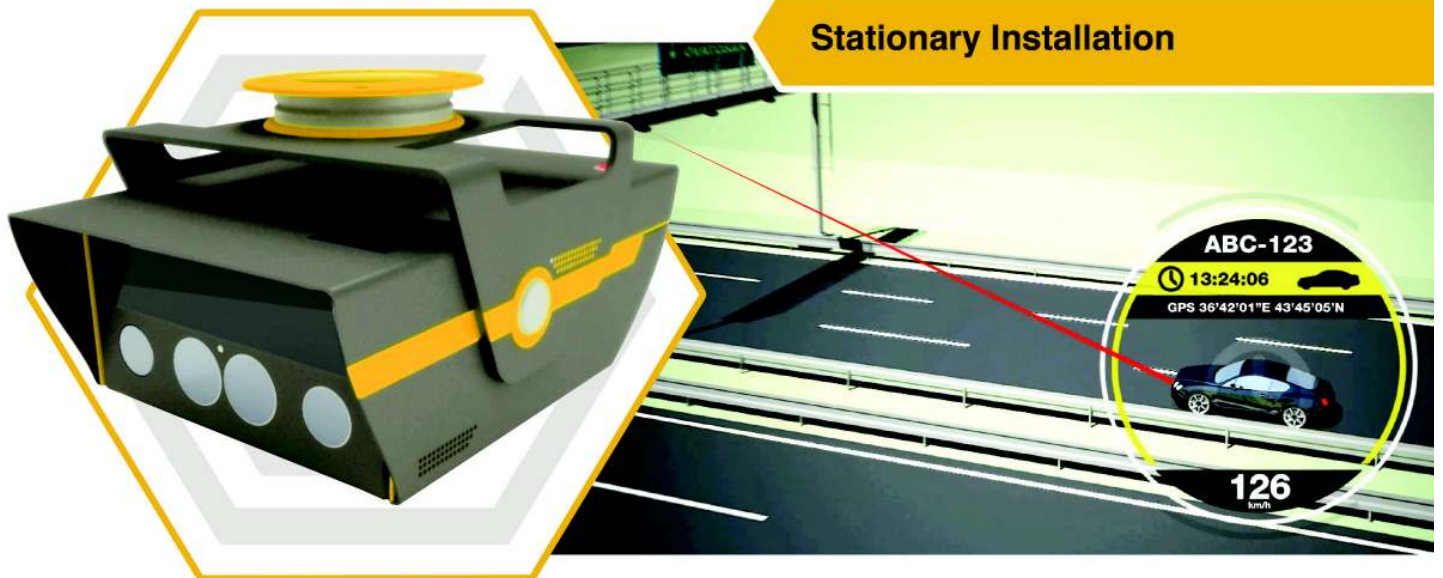

### TYPICAL APPLICATIONS

- Speed enforcement
- Section control
- Law enforcement
- Red light enforcement
- Toll collection
- Journey time measurement
- Traffic jam / congestion monitoring
- Bus lane control
- Stolen vehicle detection
- Emergency detection
- Traffic statistics
- Data transfer to/from ITS applications



**IMAGING**

FRAME RATE	5 frames/s ... 25 frames/s
SENSOR TYPE	1280 X 720 pixels; progressive scan CCD; Y/C
OUTPUT IMAGE FORMAT	JPEG; MJPEG
OVERVIEW SENSOR TYPE	1920 X 1440 pixels; progressive scan CCD; Y/C (only Stationary)
IMAGE PROCESSING	On-board robust embedded system

**OPTICS**

OPTICAL ZOOM	30x motorized (Portable)
OPTICAL ZOOM	30x motorized; 3,3x motorized (Stationary)
FIELD OF VIEW (HOR)	2.2° ... 62.9° (Portable)
FIELD OF VIEW (HOR)	2.2° ... 62.9°; 8.1° ... 26.3° (Stationary)
IR FILTER	on/off (motorized)
POLARIZING FILTER	motorized (Stationary)
IRIS	auto / manual

**ILLUMINATION**

LED TYPE	IR 850nm
----------	----------

**RANGES**

MEASURING OF THE DISTANCE	min.: 15m; max.: 1600m (with cooperative target)
MEASURING SPEED	±320km/h
SOFTWARE FILTER OF TRUE MEASURING SPEED	yes
DISTANCE / SPEED MEASURING ACCURACY	±0,02m / ±2km/h
DISTANCE OF THE IMAGE CAPTURING	160m (daytime); 100m (nighttime)

**LASER**

WAVELENGTH	905nm
LASER BEAM DIVERGENCE	0.17°
EYE SAFETY CLASSIFICATION	Class 1m (IEC 60825-1:2001)
ACQUISITION TIME OF THE SPEED	0.25s
PULSE FIRING RATE	max.: 5000Hz

**COMMUNICATION**

TYPES	WLAN, 3G, Ethernet
-------	--------------------

**POSITION TECHNOLOGY**

TYPES	GPS and optionally MDC (Magnetic Digital Compass)
-------	---

**DISPLAY (Portable)**

TYPE	SUNLIGHT READABLE TFT LCD DISPLAY (with anti-glare coating)
SIZE	7.0 inch (diagonal)
RESOLUTION	800 x 480 pixels
TOUCH SCREEN INPUT METHOD	Finger or Capacitive Pen
LUMINANCE	> 1000cd/m2

**ELECTRICAL PARAMETERS**

POWER SUPPLY	9 – 32V DC
CONSUMPTION	max.: 50W (2.6A @ 19V)
REMOVABLE MAIN BATTERY	14.8V; 10.7Ah
BUILT-IN SUBSIDIARY BATTERY	11,1V; 1.2 Ah
OPERATING TIME	4 hours (typical)

## MECHANICAL PARAMETERS

DIMENSIONS	350/465mm x 240mm x 140mm
OPERATING TEMPERATURE	-25°C ... +60°C
STORAGE TEMPERATURE	-30°C ... +60°C
IP RATING	IP67 (FIX); IP65 (PORTABLE)
WEIGHT	7kg

## ACCESSORIES

TRIPOD (only Portable)  
SEAT ADAPTER BRACKET (only Portable)  
CARRYING CASE (only Portable)  
CIGARETTE LIGHTER ADAPTER (only Portable)  
GPS AND 3G EXTERNAL ANTENNA  
AC SUPPLY ADAPTER  
CABLE SET  
SPARE BATTERY (optional)  
CLEANING KIT

## PHYSICAL CHARACTERISTICS

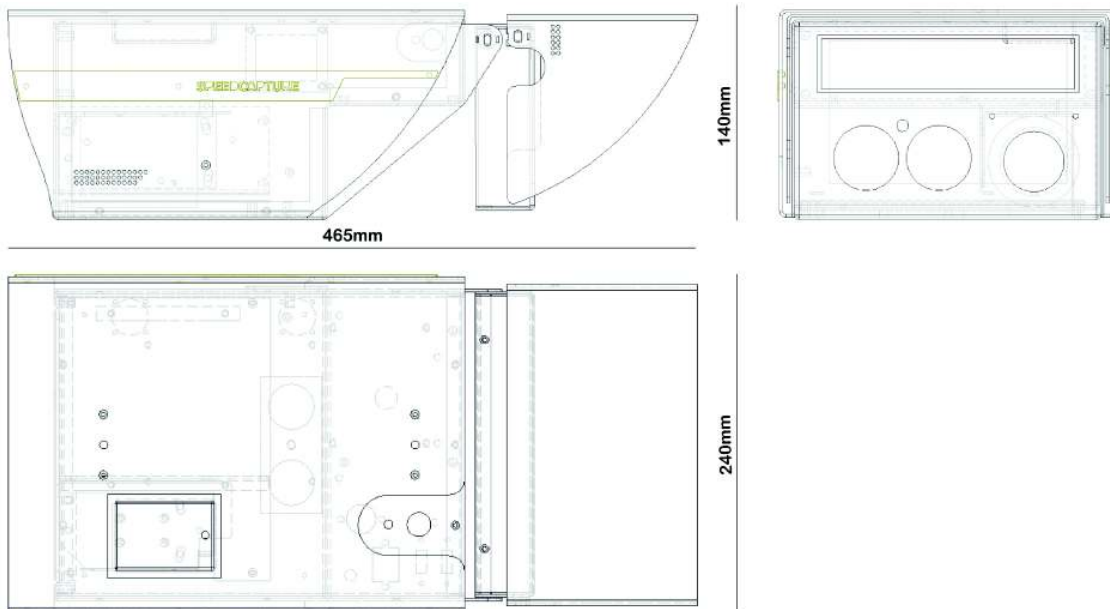

## ORDERING INFORMATION

Portable  
Portable with MDC  
Stationary  
Spare battery

SpeedCapture Portable  
SpeedCapture Portable MDC  
SpeedCapture Multisystem  
Li-ion (14.8V, 10.7Ah)

HX-SC106-PTL  
HX-SC106-PTL/MDC  
HX-SC106-STY  
HX-SC106-BAT

(C)opyright 2015 Hexium Co., Ltd.  
All text and images in this brochure are protected by copyright law.

1134 Budapest, Váci út 51/b, HUNGARY  
www.hexium.hu mail.antivir@hexium.hu  
Telephone: +36 1 320-8338 Telefax: +36 1 340-8072



Design and specifications are subject to change without notice.  
SC-106: R-1.5; 2015.06.24.